

A21凉亭接收器-说明书

公司保留更改产品设计与说明书的权利，届时将另行通知，图片仅供参考，具体以实物为准。 A/O H12238

产品简介

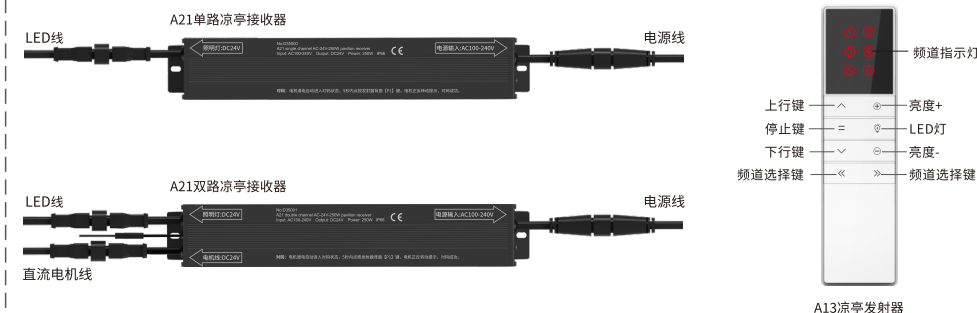

接线方式

△ 发射器切换成LED两线模式，才能接LED两线模式。
(详细操作见发射器说明：切换LED两线和LED三线模式)

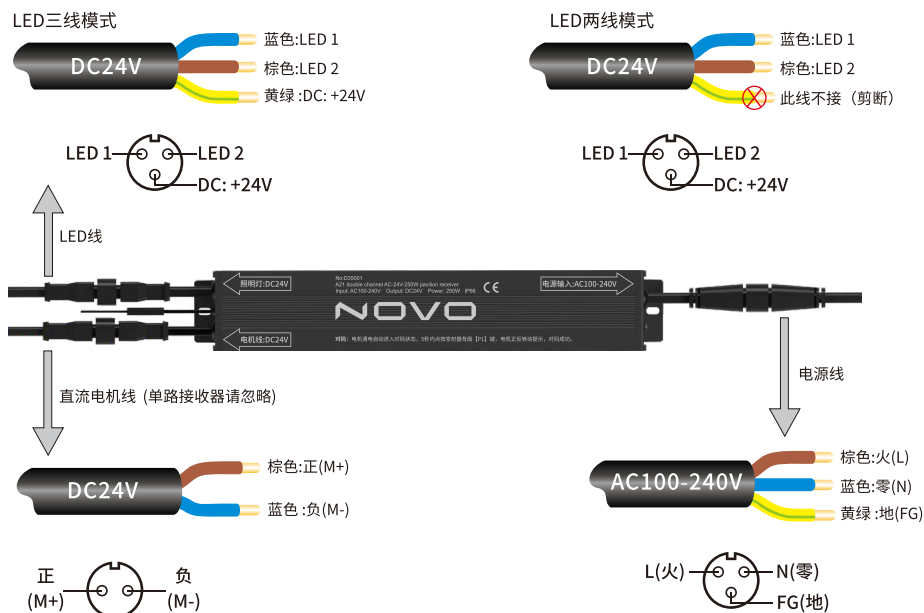

对码：电机通电自动进入对码，5秒后超时，电机无任何提示。(双路接收器电机与灯同时配对)

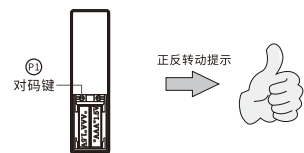

1、电机通电，5秒内按发射器【对码键】

消全码：清除电机上所有接收存储发射器的记忆，其它设置不会改变或清除（已对上码的遥控器才可进行操作）

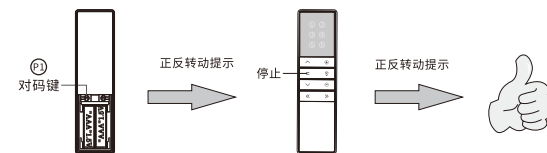

1、长按发射器【对码键】约5秒 2、长按【停止键】约5秒

切换LED灯光颜色：关灯状态下，长按"灯"键约2秒，LED灯光颜色自动切换，长按不放，3次循环后停止切换。

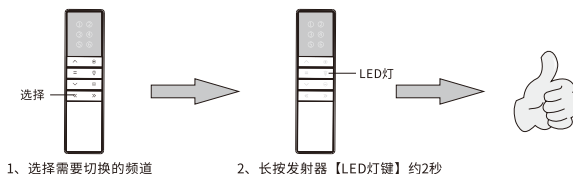

1、选择需要切换的频道 2、长按发射器【LED灯键】约2秒

切换LED两线和LED三线模式：默认是LED三线模式，重复操作是LED两线和LED三线模式相互切换。

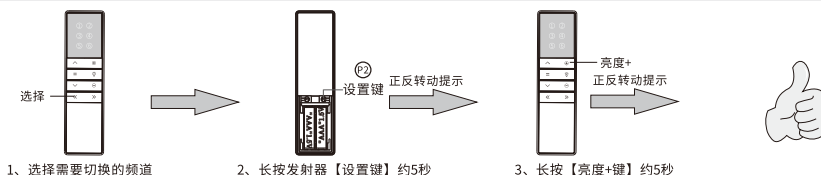

1、选择需要切换的频道 2、长按发射器【设置键】约5秒 3、长按【亮度+键】约5秒

电机换向：切换已对上码电机运转方向。如：换向前，按发射器上行键，窗帘往下运行；换向后，按发射器上行键，窗帘往上运行。

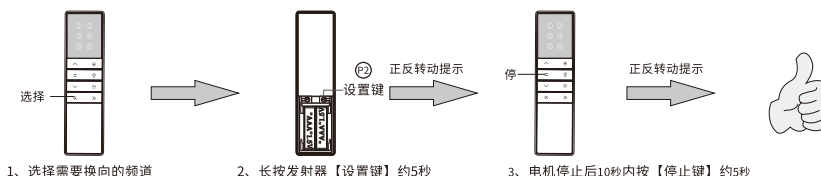

1、选择需要换向的频道 2、长按发射器【设置键】约5秒 3、电机停止后10秒内按【停止键】约5秒

复制：为已经对码的电机新增一个B发射器。

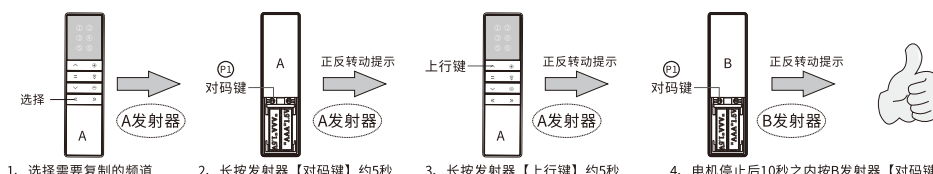

1、选择需要复制的频道 2、长按发射器【对码键】约5秒 3、长按发射器【上行键】约5秒 4、电机停止后10秒之内按B发射器【对码键】

点动/连动模式互换：电机出厂前默认为连动模式，切换为点动模式后，长按住【上行键】或【下行键】约2秒电机一直连动运转：

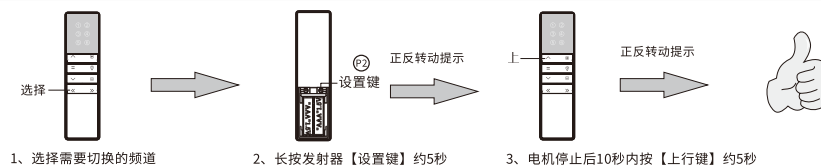

1、选择需要切换的频道 2、长按发射器【设置键】约5秒 3、电机停止后10秒内按【上行键】约5秒

A21 Pavilion Receiver Operating Manual

Company reserves the right to change product design and specifications without prior notice then, photos are for reference only. A/0 H12238

Product introduction

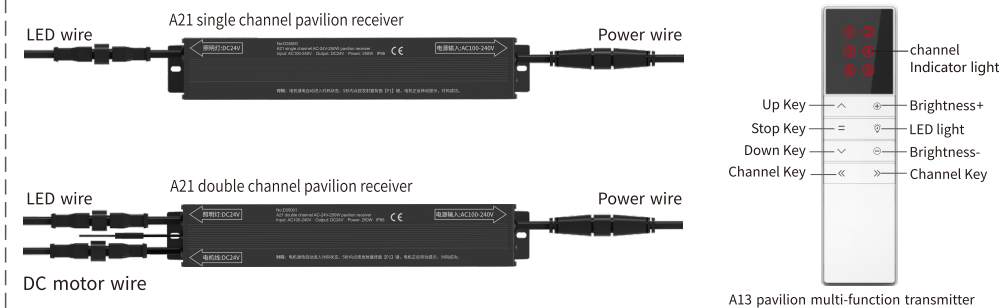

Wiring method

⚠ Switch the transmitter to LED two-wire mode before connecting to LED two-wire mode.

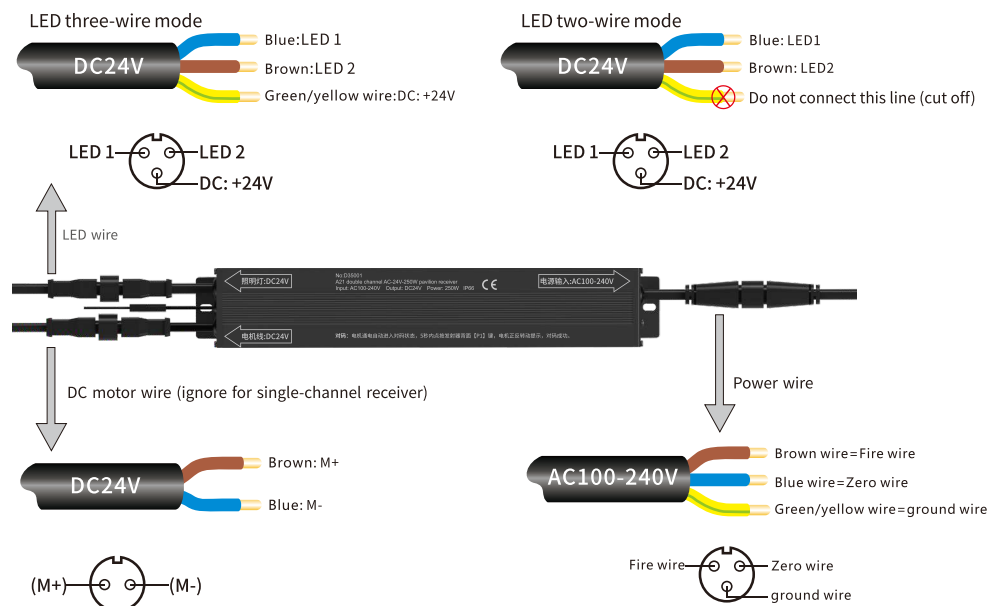

Pairing method: Motor enters pairing mode when powered on, and exits after 5s (no any prompts).

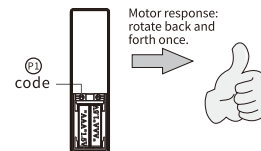

Power on motor, press transmitter [Code] within 5s

Clear pairing : Clear all pairing on the motor:

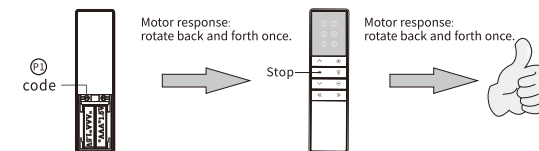

1. Press & Hold [Code] button on transmitter about 10s
2. press [Stop] button about 5s;

change light colors: When light off, press and hold the "Light" button for 2 seconds, light color will automatically change. if press and hold always, the max changing is 3 cycles.

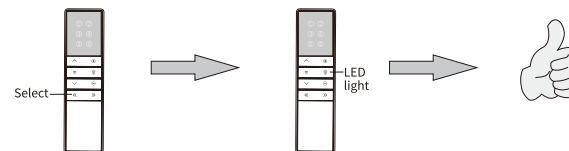

1. Select a channel that is already be paired
2. Press & Hold [LED light] button on transmitter about 2s

Switch between LED two-wire and LED three-wire mode: The default is LED three-wire mode, and repeated operation switches between LED two-wire and LED three-wire mode.

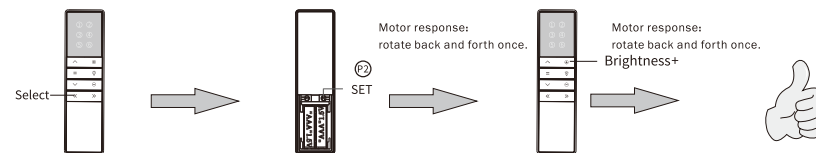

1. Select a channel that is already be paired
2. Press & Hold [Set] button on transmitter about 5s
3. Press and hold the [Brightness+] button about 5s

Reset direction: Reset motor direction. Such as: before reset, press transmitter up button, blinds runs down. After reset, press transmitter up button, blinds runs up.

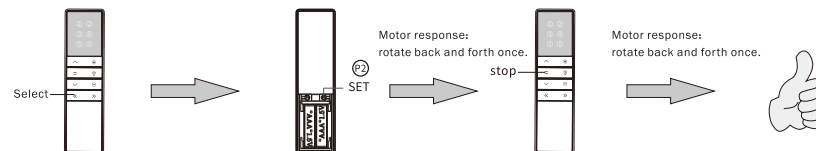

1. Select the channel that will be reset direction;
2. Press & Hold [Set] button on transmitter about 5s
3. Within 10s after motor stops, press [Stop] button about 5s

Copy: add a new channel to control motor.(No need to touch motor)

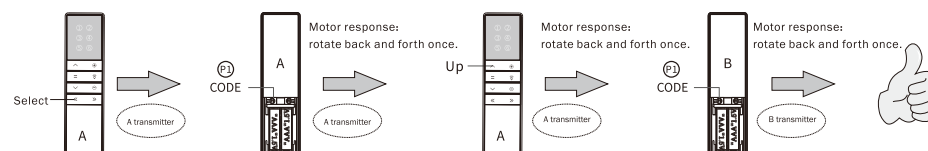

1. Select the channel that will be copied;
2. Press & Hold [code] button on transmitter about 5s
3. Press & Hold [Up] button on transmitter about 5s
4. Within 10s after motor stops, press [code] button on B transmitter

Inching / Continuous moving interchange: Default is continuous moving. After switching to inching moving, press & hold [Up] or [Down] button about 2s, motor will continuously moves:

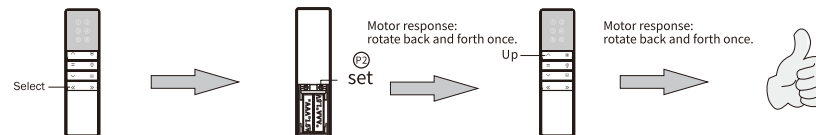

1. Select the channel that will be interchanged;
2. Press & Hold [Set] button on transmitter about 5s;
3. Within 10s after motor stops, press [Up] button about 5s;