

氛围灯开合帘电机说明书-IB

公司保留更改产品设计与说明书的权利，届时将不另行通知，图片仅供参考，具体以实物为准。

A/0 H12193

产品简介

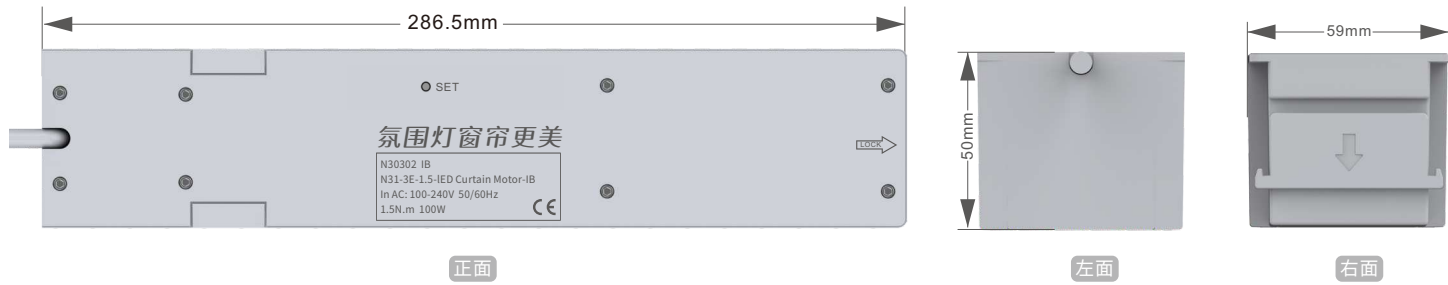

操作说明（*以A13-2频发射器为例进行说明，其它发射器请参考相应的发射器说明书。）

对码：重复操作对码步骤即消除当前码：



复制：为已经对码的电机新增加一个发射器：



换向：切换已对上码电机运转方向。如：换向前，按发射器打开键，窗帘关闭,则需要进行换向设置：

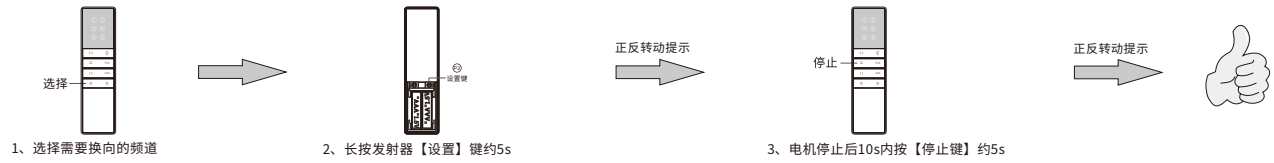

行程取消：



氛围灯设置：电机运行时自动打开氛围灯，重复操作即关闭和打开相互切换，关闭后按“开灯”键才可以打开氛围灯：



面料反弹方向和启用面料反弹设定：



干触点排线定义

1.红色线	公共端，接干触点开关公共端		
2.黄色线	LED 灯控制线,按一次 LED 灯打开,再按一次 LED 灯关闭		
3.白色线	CLOSE 线，按一次开合电机合上，再按一次开合电机停止		
4.灰色线	OPEN 线，按一次开合电机打开，再按一次开合电机停止		
5.绿色线	模式选择	(1) 做绝缘	黄色线-LED 灯控制线,按一次 LED 灯打开,再按一次 LED 灯关闭
			白色线-CLOSE 线，按一次开合电机合上，再按一次开合电机停止
		(2) 接到公共端	A、长按不放白色线按键，开合电机合上;松开按键，电机停止
			B、长按不放灰色线按键，开合电机打开;松开按键，电机停止
注:黄色线、白色线、灰色线根据自己喜好接到相应干触点按键			

接线示意图：

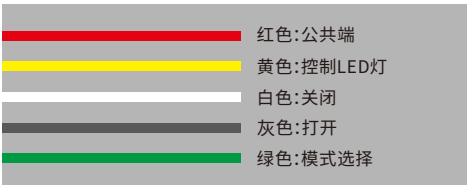

Ambient light curtain motor instructions

Company reserves the right to change product design and specifications without prior notice then ,photos are for reference only. A/0 H12193

Product Introduction

Take the N31-3E-1.5-LED curtain motor as an example

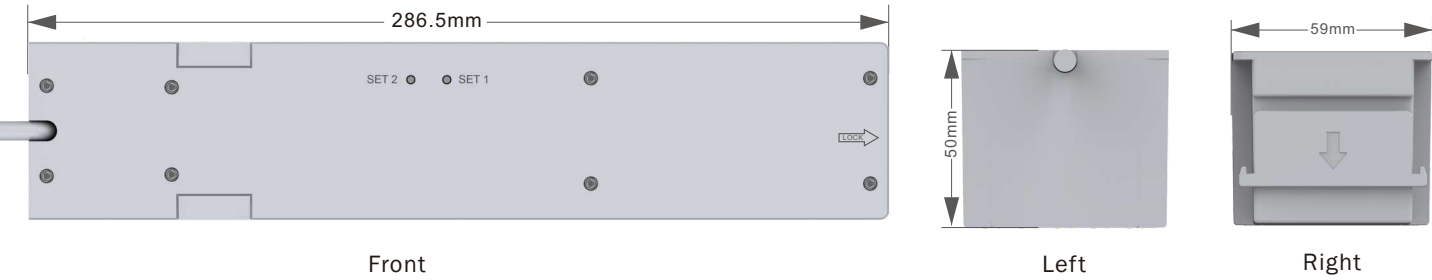

Instructions: (Take A13-2 button transmitter as an example, for other transmitters, please refer to the corresponding transmitter manual.)

Pairing transmitter and motor

Repeat the steps to clean current pairing

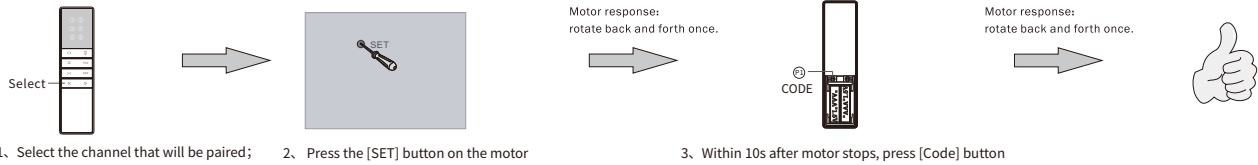

copy add a new channel to control motor. (No need to touch motor)

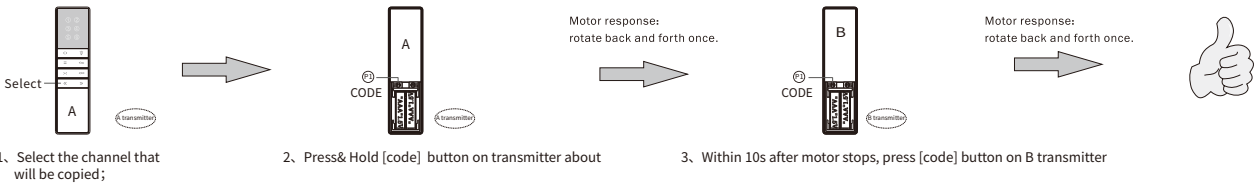

Reset direction

Reset motor direction. Such as: before reset, press transmitter up button, blinds runs down. After reset, press transmitter up button, blinds runs up.

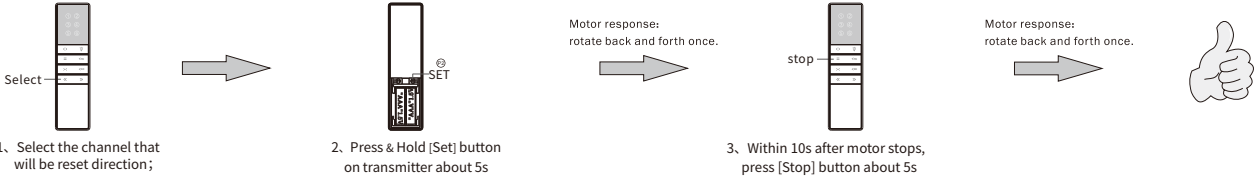

Cancel limit

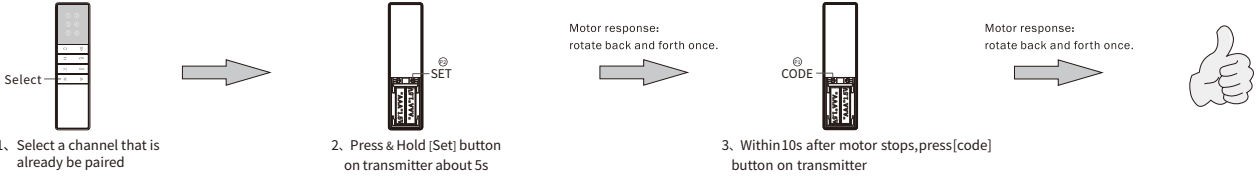

Ambient light setting

Default: ambient light is automatically turned on when motor is running. After below setting, light will not turn on when motor is running. Repeat the setting,it will turn on when motor is running. When light off, press the "On Light" button of remote to turn on the light.

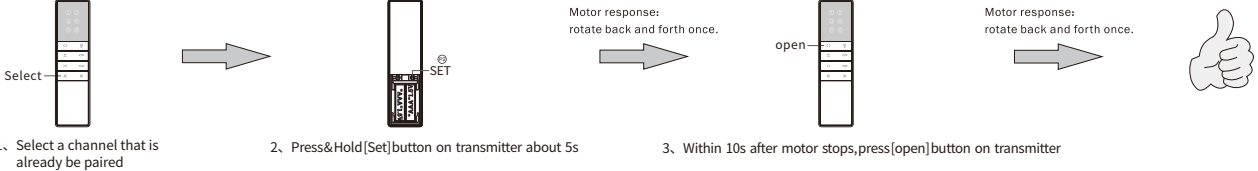

Fabric rebound location exchange setting

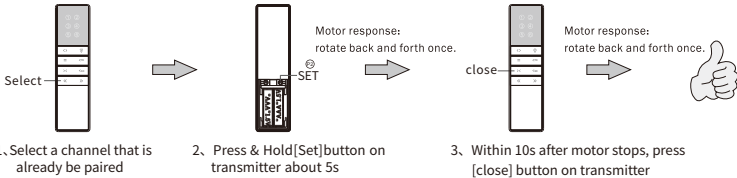

Restore factory settings

clear all settings on the motor and restore to the default state

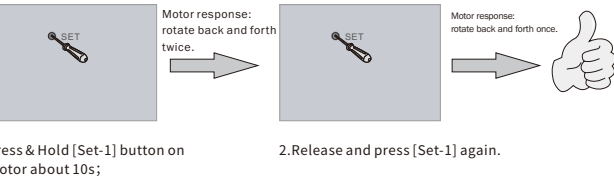

Dry contact wires description

1.red wire		Common	
2.yellow wire		Control LED light, press to turn on LED light, press again to turn off LED light	
3.white wire		Close wire, press to close curtain, press again to stop curtain	
4.grey wire		Open wire, press to open curtain, press again to stop curtain	
5.Green wire	Choose model	(1) Make insulation	yellow wire-control LED light, press to turn on LED light, press again to turn off LED light
			white wire-Close wire, press to close curtain, press again to stop curtain
		(2) Connect Common	A、Keep pressing white wire button, curtain will close; Release button, curtain stops.
			B、Keep pressing grey wire button, curtain will open; Release button, curtain stops.
Remark: connect yellow, white and grey wires according to your will			

Wiring diagram

